

DOCKET
September 19, 2023 Stated Meeting of Maumee Valley Presbytery
“Worshipful Work”
First Presbyterian Church, Tecumseh, MI

1:45 Registration begins - *located in the gathering space off the parking lot*
 (map – attachment 1a).

2:00 Open Spaces begin (attachment 1b)

Gathering and Getting Organized: Sanctuary

Prelude

3pm Call to Order Chas Myers

Opening Prayer and Lighting of the Christ Candle Cathi King

Call to Worship *The Blessing of Jesus*, John Philip Newell

Blessed are those who know their need
for theirs is the grace of heaven.

Blessed are the humble
for they are close to the sacred earth.

Blessed are those who weep
for their tears will be wiped away.

Blessed are the forgiving
for they are free.

Blessed are those who hunger for earth's oneness
for they will be satisfied.

Blessed are the clear in heart
for they see the Living Presence.

Blessed are the peacemakers
for they are born of God.

Friends, we gather this day
 to celebrate life—
 the life we have been given by God,
 the life we share with one another in community,
 the life that Jesus gives in abundance.
 Let us be grateful for the joy of life,
 and let us worship God.

HYMN *Jesus Be With Us*

**Declaration of Quorum
Adoption of Docket
Report of the Clerk**

Dean McGormley

- 3:20 Report of General Presbyter** (attachment 2) Matt Meinke
- 3:30 Synod Report** (attachment 3) Chip Hardwick
- 3:35 Report of Mission Commission** (attachment 4)
Commissioning of the Kentucky PDA Mission Trip
- 3:55 Report of Discipleship Commission** (attachment 5)
- 4:25 Report of Leadership Commission** (attachment 6)
- 4:35 Break *(not to exceed ten minutes)*
- 4:50 Central Support** (attachment 7)
- 5:35 Commission for Churches Concluding Ministry – Forest First** (attachment 8)
- 5:45 Nominations** (attachment 9)
- 5:50 Offerings of Thanksgiving and Music**

Anthem *“I Believe”* St. Andrew’s Choir
Prayer

6:00 Dinner and Continuing Worship Knox Hall

Seated in Geographic Community Groups by color: Tables of 8
Table tent cards: Community Group and Centering Verse:

Early Christian Community: *They devoted themselves to the apostles’ teaching and fellowship, to the breaking of bread and the prayers.* - Acts 2:42

Every seat has a placemat by color with questions on each side

Table Groups: Sharing of Side A

1. What makes you feel welcome?
2. What is community?
3. Describe the community of your congregation.
4. What does your congregation offer to your community?

Hymn #70 What Does the Lord Require of You?

Scripture: Acts 4:32-37 Building Community

The word community originates from the words *common* and *unity*. In Acts chapter 4, we have a longer description of the way the early church lived in community with each other. Listen for the way these two words: *common* and *unity* formed the essence of their lives together:

Now the whole group of those who believed
were of one heart and soul,
and no one claimed private ownership of any possessions,
but everything they owned was held in common.
With great power the apostles gave their testimony
to the resurrection of the Lord Jesus,
and great grace was upon them all.
There was not a needy person among them,
for as many as owned lands or houses
sold them and brought the proceeds of what was sold.
They laid it at the apostles' feet,
and it was distributed to each as any had need.
There was a Levite from Cyprus, Joseph,
to whom the apostles gave the name Barnabas
(which means "son of encouragement").
He sold a field that belonged to him,
then brought the money and laid it at the apostles' feet.

This is the word of the Lord. **Thanks be to God.**

Table Groups: Sharing of Side B

*-A few minutes for everyone to write on their placemats
-A few minutes of sharing in table groups*

Think about the larger community in which your church is located:

1. What other organizations serve this community?
2. Are there some who are underserved in your community? Who or where are they?
3. How might the churches in your community group work together to meet these needs?

Celebration of Communion

Song of Preparation
Invitation
Great Prayer of Thanksgiving
Sharing of the Elements in Table Groups
Praying for each other's congregations and the world

Charge to the Churches

“Christ has no body **but ours**.

No hands, no feet on earth **but ours**.

Ours are the eyes through which

Christ looks with compassion on this world.

Ours are the feet with which

Christ walks to do good.

Ours are the hands with which

Christ blesses all the world.

We are the hands.

We are the feet.

We are the eyes.

We are the body of Christ.

Christ has no body now **but ours.**”

Holy Spirit,

you have given many gifts and talents to each of us. Nurture these gifts and help us use them wisely for others. Inspire us to encourage others to use their gifts as well. Make us a complete body of Christ. Amen.

Passing of the peace

Closing Song (*refrain*) ***Jesus Be With Us***

*Jesus, be with us, Help us each day to follow the gospel and live as we pray.
Send us your Spirit and show us your way. Jesus, be with us today.*

Blessing

Go now into the world as the body of Christ. And may the love of God, the grace of our Lord Jesus Christ, and the fellowship of the Holy Spirit be with you, and all God’s children. Amen.

7:45 Motion for Adjournment

Tecumseh First Presbyterian Church grounds

1a

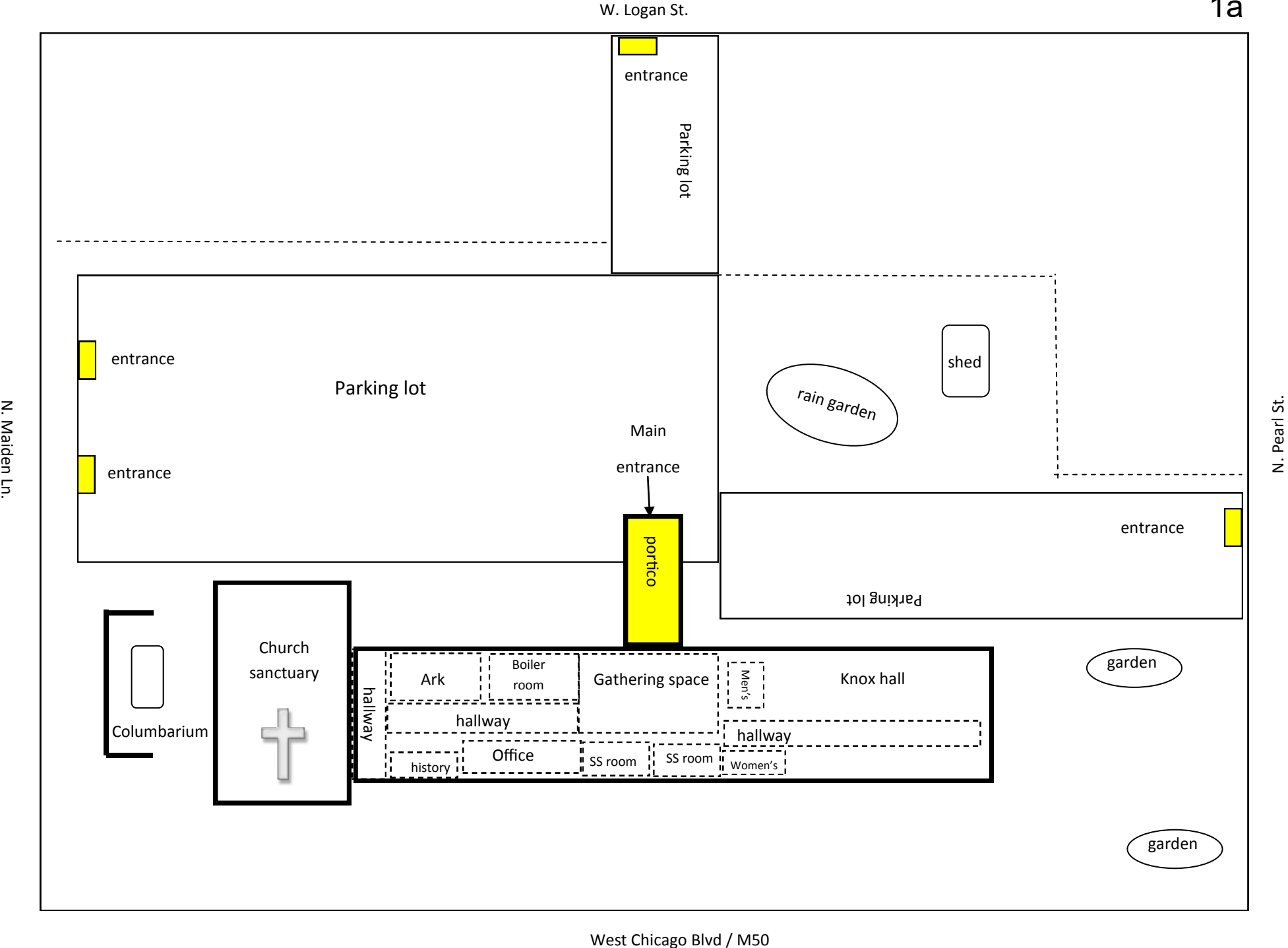



Open Space Opportunities @ FPC Tecumseh

**September 19, 2023
2:00-3:00 p.m.**

We will begin in the Sanctuary to introduce different opportunities, and then break out to different locations. Open to ALL, guests and visitors encouraged.

Native Gardens and Sacred Grounds

Lee Walsh and Amy Remaklus, Leaders

Come see the FPC Tecumseh Rain Garden, hear stories of this congregation's work in native plantings, and hear from Toledo Campus Ministry Executive Director Rev. Amy Remaklus on her work with native gardens at the University of Toledo. (Discussion begins at 2pm and the Garden Tour portion of this Open Space will happen at 2:30)

Guidelines for Session Personnel Committees

Rev. Tom Steensma (Leadership Commission), Leader

There are both opportunities and pitfalls for those charged with reviewing lay and clergy staff. This workshop is designed for new and for seasoned Personnel Committees, as well as others who evaluation the work of lay and clergy staff.

English as a Second Language as an Outreach Program

Rev. Leo Pech, Leader

Are you considering hosting ESL Classes, or interested in hearing how this can be a powerful outreach ministry? Join Rev. Leo Pech as he shares about the Mission, purpose, plan, materials, organization, networking, and volunteers needed for an ESL Program in your church.

Community Partners and Opening Your Building

Kevin Burchett & David Hammond, Leaders

Come share ideas on how opening the church building to community partners has been a means of engaging the community, and expanding the mission beyond Sunday morning, and building needed revenue. This conversation will be lead by leaders of FPC Tecumseh.

Also—there will be an **Organizational meeting at 2:00pm**
for those attending the MVP PDA trip in October to Kentucky.

General Presbyter Report

September 2023

For our Common Life:

1 New Book of Order Requirements

There are a number of new Book of Order requirements, of which many of you are aware as we voted on these amendments to the Book of Order just a few months ago. Boundary Training is now required at all council levels, including sessions. There are also requirements regarding Anti-Harassment policies and Anti-Racism policies. What to do? How to implement?

I will be making a presentation at presbytery regarding some hopeful and creative possibilities for you all, ones that look at these requirements on a larger scale than just our presbytery, namely the plans of our Synod and national church. I have been working on this in partnership with others in our Synod, so that greater resources may come for all.

2 1001 New Worshipping Communities

Since we last gathered, the Mission Commission has been hard at work paving new and easier ways for new worshipping communities to emerge. There is a new manual that they have adopted, which allows for more transparency in the process, accountability, and ease in locating funding.

My challenge to you all is to let go of our (all too often) one dimensional thinking about NWCs, and dream big with God once again. My goal for us is **20 new worshipping communities in Maumee Valley in the next 10 years.**



I believe we may well be on our way with this, as I converse with many of you.

If you are feeling the Spirit nudge you toward new adventures, consider helping plant a New Worshipping Community. Consider joining an Online Cohort. Also the online Accelerator cohort is a 6-week exploration that covers topics such as practical financial management, creating vision, funds development, missional theology, developing partnerships, communicating your story, and more.

3 Ordiversaries!

Each meeting I will be celebrating some amazing milestones, with ordination anniversaries

Check out the attached ordiversary list for 2023 (attachment 2a). If there are any corrections or additions you know of, please call this to my attention before the meeting.

4 MVP Newsletter - The Newsletter is a great way to connect in with the many resources we have. As presbytery commissioner you may want to include in your report to your session an invitation to join the newsletter list. <https://mailchi.mp/4fbe4c4d95a5/newslettersignup>

Help us be the connectional people we desire to be!

5 Boundary Training for Ministers

Every three years each pastoral leader is required to take boundary training. We normally offer in-person trainings, but this year details have been slower in coming into focus than normal. We are hopeful to be offering in-person Boundary Training by early next year. In the meantime, the Synod has two online possibilities.

Introduction to Boundary Training (offered in partnership with Leaderwise)

October 2-3, 2023 from 6:00-8:30pm

Or

November 7-8, 2023 from 1:00-3:30pm

For full details visit: <https://synodofthecovenant.org/leadership-development-workshops/>

Ordination Milestones/Anniversaries in 2023

70 Years

George L Bell (6/19/1953-Toledo)

60 Years

David C Koch (10/1/1963-Cincinnati)

55 Years

Gavin Pitt (6/4/1968-Chicago)

Henry Snedeker-Meier (6/9/1968-New Castle)

50 Years

Jack Lemon (6/6/1973-Detroit Conference UMC)

Ricky Hoff (6/10/1973-Chicago)

Ralph Middleton (7/1/1973-Transylvania)

40 Years

David Good (1/23/1983-Detroit)

30 Years

Ann Marie Montgomery (9/5/1993-Western Kentucky)

20 Years

Jin Seung Kim (4/22/2003-Eastern/Korean Presbyterian Church in America)

James Hodsden (6/28/2003-Muskingum Valley)

15 Years

Matthew Zuehlke (7/27/2008-Quaker/Friends-Wilmington Yearly Meeting of Friends)

Thomas Emery (9/28/2008-Cincinnati)

5 Years

Mary Beth McCandless (5/20/2018-Mid-Kentucky)

September 2023

3

The Synod of the Covenant

Presbyterian Church (U.S.A.)

Upcoming Synod Programs and Ministry

Matthew 25 Scholarships for Christian Leaders (for undergrad, associates, vocational and seminary students): 44 Awardees from 9 presbyteries for a total of \$40,500. 23 of the winners self-identified as Black, Korean, Asian, or African.

Matthew 25 Grants for Congregations Working to Build Congregational Vitality, Dismantle Structural Racism, and/or Eradicate Systemic Poverty

- Up to \$5,000
- Submit Applications by 9/30/23

Zoom Workshops

- 9/6/23 10:00 – 11:30 am: **Preaching Workshop** “Exploring the Themes of Advent 2023” with Rev. Dr. Chip Hardwick of the Synod of the Covenant
- 9/11 and 9/14/23 6:00 – 8:30: **Child Sexual Abuse Protection Training** (LeaderWise)
- 9/13, 9/27, 10/11, 10/25/23 10:00 – 11:30 am: **The Leader’s Table** Cohort meetings
- 10/2-3 6:00 – 8:30 pm and 11/7-8/23 1:00 – 3:00 pm **Boundaries Training** (LeaderWise)
- 10/4/23 10:00 – 11:30 am: **Preaching Workshop** “A Refresher Course on the Basics of Sermon Preparation” with Rev. Dr. Cleo LaRue of Princeton Theological Seminary

Fourth Sunday of Advent Worship Service The Synod will provide a virtual worship service for use the morning of Christmas Eve.

For more information visit www.synodofthecovenant.org or contact Synod Executive Chip Hardwick at chip@synodofthecovenant.org or 309-530-4578.

We’re the Synod of the Covenant.

In our Synod, we’ll try anything to equip and support leaders for God’s emerging, creative future.

From: Mission Commission
Date: 08/31/23
Subject: Minutes since last MVP meeting

ACTIONS TAKEN ON BEHALF OF PRESBYTERY:

1. Mission Commission adopted a manual adapted from the successful model from the Pittsburgh Presbytery to serve as our operational manual for 1001 New Worshipping Communities. *(See Attachment 7g in packet 2)*
2. The Mission Commission will act as the New Worshipping Communities Commission, until such a time as the presbytery can meet to adopt a new standing committee and amend its Operational Procedures.

RECOMMENDATIONS TO PRESBYTERY:

1. 2024 Recommendations to the budget: #5374 (Mt. 25 grants) reduced from \$10,000 to \$5,000 with the \$5000 reduction going to #5377 (New Worshipping Communities – NWC Commission); all other budget line items remain the same.

Rationale: We hope to prioritize the formation of New Worshipping Communities in the coming year, and we know Mission Commission will be helping to underwrite training and key administrative costs. Also, we have more money allocated for Mt. 25 grants than applications require. We believe NWC will have a greater need for these funds in the coming year.

INFORMATIONAL ITEMS:

1. Bryan and Defiance congregations are working together on a mission trip to provide Vacation Bible School in the Yucatan Peninsula: Prince of Peace Presbytery next July 20- 30, 2024. Leo Pech and Rich Reid will present at the September MVP meeting.
2. Peace and Global Witness Offering: 9/3-10/1: "You are with me" – Mission Commission is collecting stories about how our MVP congregations will use the retained portions of this offering to inspire each other in mission.

From: David Hammond & Jim Miller

Date: August 29, 2023

Subject: Discipleship Commission Report

ACTIONS TAKEN ON BEHALF OF PRESBYTERY:

none

RECOMMENDATIONS TO PRESBYTERY:

none

INFORMATIONAL ITEMS:

1. *Canoeing The Mountains* – James Hodsden

- Saturday, October 7, 2023 – Sandusky Presbyterian Church (see attachment 5a)
- Sponsored by the eastern churches of MVP and the Discipleship Commission

2. Spiritual Formation Team – Ann Marie Montgomery

- 2023 Fall Retreat – October 8-10 (see attachment 5b)
- 2024 Spring Retreat – April 14-16

3. Kirkmont – David Bartley

- Camp Rejoice
- REKIndle Fall Youth Retreat – Nov. 10-12, 2023 (see attachment 5c)

4. CRE Program Resources

- [Pathways to Online Courses](#)
- Registration is open 2023-2024 Academic Year.
- Open to all, including those desiring to become Commissioned Ruling Elders as well as church and community members who want to further their education and discipleship.

5. Boundary Training Update – Clint Tolbert

- Additional opportunity/information from Clint (see attachment 5d)

Respectfully Submitted – David Hammond (Co-Chair), Jim Miller (Co-Chair), Kevin Clancy, Sara Hodsden, Ken Krieger, Amy Remaklus, Matt Meinke (Ex-Officio)



Fall Event - Canoeing the Mountains: Christian Leadership in Uncharted Territory

October 7, 2023

Maumee Valley Presbytery, Eastern Cluster of Churches invites you
to Canoeing the Mountains: Christian Leadership in Uncharted Waters

Rev. Dr. Tod Bolsinger, the author of *Canoeing the Mountains*, will be at First Presbyterian Church of Sandusky on October 7. Check-in begins at 8:45 am with morning prayer at 9:15 am. First Presbyterian Church of Sandusky is located at 265 Jackson Street.

Special Registration is \$30 until September 22.

Regular Registration is \$35 until September 30.

Cost includes buffet lunch and morning refreshments.



Maumee Valley Presbytery Invites you to our

5b

Fall Spiritual Formation Retreat

October 8, 9, 10, 2023

True Identity: You Are Not Your SS #!

Featuring Sr. Joanne Mary Frania of the Sisters of Notre Dame.

Sr. Joanne currently ministers as a spiritual director for individuals and groups. She has an ecumenical bent, a good sense of humor and a grateful passion for God's love and grace. Here are a few snippets of her thoughts:



Location:

**Lial Renewal Center,
5908 Davis Road
Whitehouse, Ohio
www.lialrenewalcenter.org**

Arrive Sunday

anytime after 3:00 p.m.
A lite supper will be
available at 5:30 with
devotional time beginning
at 7:00 p.m.

**Depart Tuesday
at noon**

BASIC RETREAT

\$25 per person for
all sessions and meals

OVERNIGHT LODGING

\$35 per person/per night
with a shared bathroom on the hall

\$40 per person/per night
with a private bath

Don't let the cost stop you!
Scholarships available!

Email matt@maumeevp.org **MEEVP.ORG**

REGISTRATION:

www.maumeevp.org

God knew you!

God knows you!

God loves you!

God captures and leads you!

Before time began,

God had God's heart set on you—

as God does today for the Life of the world.

You are not your social security number,

the picture on your driver's license,

maybe even who you think you are.

Believe that?

Listen—

God gave you a special mission in this life which continues to

be revealed, continues to evolve. We'll take some time to revisit

that awesome reality and perhaps you will discover you are

more than you think you are—or are not!

***"You created my inmost self;
knit me together in my mother's womb"***

Psalm 139:13

Rekindle

2023 MVP Youth Retreat

WALKING THE PATH

Come enjoy a fun, faith-filled, and inspiring weekend for all youth grades 7-12!



**Friday Nov. 10th 7:30p -
Sunday Nov. 12th 11:30a**

**Retreat located at
Kirkmont Center**

**Cost is \$15 for Early Bird
Registration by Sept. 30th
\$25 for registration on or after
October 1st**

Registration Ends October 30th

Register TODAY on the MVP website: www.maumeevp.org

**Sponsored by the MVP Discipleship Team: e-mail Rev. David
Bartley for more information dbrev1@juno.com**



MIDWEST^{5d} GATHERING

October 27 & 28

Centered & Soaring

Featuring **Stan Ott** with **Lee Zehmer**

Isaiah speaks of those who take root downward and bear fruit upward. Join us as together we grow new roots—**centered** on the Lord who loves us — and bear new fruit—**soaring** in the life God gave us.

Join us in person at any of three locations:

(\$50 per church or \$10 individual)

First Presbyterian Church



110 Calvin Rd.
Rochelle, IL 61068
[https://forms.gle/
2BdDWLL5j3gg26RLA](https://forms.gle/2BdDWLL5j3gg26RLA)

The gathering is scheduled for Friday evening and Saturday morning. Please click on the registration link for scheduling details

First Presbyterian Maumee



200 E Broadway
Maumee, OH 43537
[https://fpm.churchcenter.com/
registrations/events/1904860](https://fpm.churchcenter.com/registrations/events/1904860)

Cranberry Community United Presbyterian Church



2662 Rochester Rd
Cranberry Township, PA 16066
[https://
ccupc.churchcenter.com/
registrations/events/1904140](https://ccupc.churchcenter.com/registrations/events/1904140)

REPORT TO PRESBYTERY LEADERSHIP COMMISSION SEPTEMBER 19, 2023

Actions Taken on Behalf of the Presbytery:

Approved the transfer of the Rev. Karol Farris Schilling from MVP to Great Rivers Presbytery effective March 1, 2023.

Approved the transfer of the Rev. Karen Rose VanderPloeg from MVP to Ohio Valley Presbytery, effective March 20, 2023.

Enrolled the Rev. Ruth Clendenin (Christ Toledo) as a member of MVP effective May 1, 2023 and the Stated Clerk to request her transfer from South Dakota Presbytery

Approved the Installation Commission for the Rev. Ruth Clendenin as pastor of Christ Presbyterian Church, Toledo: Chas Myers, Moderator; Don Loving (RE Tiffin), Phil Minton (RE Christ), Rev Jeanne Gay, Rev Barbara Esterly; 2:30 pm on Sept 10, 2023 at the church; Commission was empowered to add and replace members as needed.

Enrolled David Aber as a member of Maumee Valley Presbytery effective August 4, 2023 and instructed the Stated Clerk to request his transfer from Eastminster Presbytery. Welcome back, David.

Approved the Temporary Supply Contract between Bill Treadway (RE Tiffin) and Waterville Presbyterian Church, effective August 28, 2023, 30 hours per week:

Cash Salary:	\$ 2916.67/ month (\$ 35,000 per year)
Ministry Expenses:	\$1000 / quarter
Minister's Choice through Board of Pensions:	\$3620 / year
Deferred Compensation:	\$1200 / year
FSA:	\$2000 / year
HRA:	\$2000 / year
Matching Annuity:	\$1200 / year
Continuing Education Expense:	\$1500 / year

2 Weeks Continuing Education (cumulative up to 6 weeks in 3 years)

4 Weeks Vacation including 4 Sundays

The loan for CRE training made to Lance Wiesmann in 2013 has been forgiven. MVP policy is that such loans can be forgiven provided the student is a CRE commissioned to a church for at least 24 months. Lance fulfilled that requirement in his work at Ottawa.

For Information

Church Leadership Connection has transferred to a new system for pastoral and staff searches. Those seeking a call file a PDP: Personal Discernment Profile and PNCs or other search teams submit the MDP: Ministry Discernment Profile. These are significantly different forms from the previous PIF and MIF. As of August 31, the old system is no longer operating. Some “bugs” are still being worked out in the new system.

The Church Leadership Connection has some online training materials for the new PDP and MDP and Matt has some resources from his colleagues to help understand some of the new sections of the forms.

The Leadership Commission hosted a Zoom meeting with CLC staff and our liaisons in late June. CLC is available by appointment for any PNC or search team to meet with once their MDP is live in the system.

Training videos are becoming available for calling organizations and PNCS: Go to <https://oga.pcusa.org/section/clc/clc/clc-calling-organizations-churches/> then scroll down to Tutorials/Videos/Webinars to view videos.

Call Seekers: The CLC hosted a training session on the PDP for call seekers: the link to that recording is <https://oga.pcusa.org/section/clc/clc/clc-call-seekers/> then scroll down to Tutorials/Videos/ Webinars to view that video and other tutorials.

The Vision Team of the Leadership Commission has a presentation of materials to get us all talking about “What’s Next” for our ministries. Please share this resource with your session and leaders now, whether or not your congregation is in transition. A big thank you to Jeanne Gay for compiling this resource, and to Julie Kling for preparing our power point. See the handout (available at registration) as we begin our presentation.

Ann Wasson, Moderator, with Ron Boyd, Carole Burnworth, Doris Chandler, Jeanne Gay, Julie Kling, Jeff Schooley, Tom Steensma, Joel Youkers

CENTRAL SUPPORT SEPTEMBER 2023**Katie Treadway****ACTIONS TAKEN ON BEHALF OF PRESBYTERY:**

1. Received the "INDEPENDENT MINI THIRD-PARTY FINANCIAL REVIEW" of MVP finances dated 7/25/2023. **(attachment 7f – can be found in packet 2)**
2. Received the MVP Stated meeting schedule for the next five meetings.
Meeting schedule
November 14, 2023 at Findlay – Jessie Commeret on sabbatical; will work on planning when she returns
February 20, 2024 virtual – worship will be led by East Region group of small church leaders; specifically. Julie Kling, Bobbie Bella, Rose Jones, Sara Hodsden, and Don Loving. Theme not yet determined.
May 21, 2024 at First Presbyterian Church Monroe – Rev. Doris Chandler, worship plans not developed yet.
September 17, 2024 – waiting on a Session approval
November 19, 2024 10:00 am at First Presbyterian Church of Bryan – Rev. Leo Pech, worship plans not developed yet.

RECOMMENDATIONS TO PRESBYTERY:

1. **ON MOTION** to replace the former Mission distribution (Presbytery 70%, Synod 27%, G.A. 3%) with a new distribution (Presbytery 75%, Synod 22%, G.A. 3%)
2. **ON MOTION** to approve a \$.55 increase in the per capita for 2024 (New per capita total of \$39.10 with the \$.55 Pres increase and \$.05 G.A. decrease)
3. **ON MOTION** to approve the 2024 presbytery budget. (proposed budget has a \$.55 increase in per capita) {see **Attachment 7b – in packet 1**}
4. **ON MOTION** to **Amend the Manual of Operations by adding the following to SECTION 3 of the Operational Procedures (following the Mission Commission entry):**

NEW WORSHIPPING COMMUNITIES COMMISSION

The New Worshipping Communities Commission shall be composed of six (6) members, composed of ministers and ruling elders. The general presbyter and stated clerk are ex-officio members, without vote. Members should have experience, knowledge, expertise or willingness to undergo training in the area of New Worshipping Communities. Other individuals, including members and leaders of new worshipping communities, regardless of ordination status or congregational membership, may be invited by the commission to serve in a non-voting capacity when the commission determines such participation would support the commission's work and mission.

The commission shall serve the presbytery in the following ways:

- a. Establish, oversee, and dissolve all New Worshipping Communities and Fellowships, and their Task Forces/Leadership Teams. Each New Worshipping Community and Fellowship will be governed by a Task Force/Leadership Team authorized by the NWC Commission. The Task Force shall have responsibility and authority similar to that of a church session and appropriate to the

- context (including the calling of a leader), as determined by the NWC commission, and accountable to the NWC Commission and Leadership Commission in the case of pastoral calls.
- b. Maintain a Manual that governs the establishment, development, oversight, and processes for NWCs.
 - c. Strategize the overall continued growth of new worshipping communities within the bounds of Maumee Valley Presbytery.
 - d. Encourage and coordinate congregational efforts to engage in local or multi-congregational new worshipping community experimentation
 - e. Pursuant to G-3.0109b, provide examination for leadership utilizing the approved terms of call, and dissolve the relationships of leaders of New Worshipping Communities and Fellowships. The membership status, pastoral calls, and ministry contracts of Ministers of Word and Sacrament serving New Worshipping Communities and Fellowships in Maumee Valley Presbytery will continue to be subject to the examination and approval process of the Leadership Commission (COM) in consultation with NWCC
 - f. Distribute presbytery allocated resources in support of New Worshipping Communities and Fellowships.
 - g. Monitor and evaluate the progress of New Worshipping Communities and Fellowships.
 - h. Authorize the administration of the sacraments in New Worshipping Communities and Fellowships.
 - i. Communicate regarding New Worshipping Communities and Fellowships, and report the commission's actions on behalf of the presbytery.
 - j. Recommend that presbytery charter a New Church when appropriate, in consultation with Leadership Commission.

AND to Amend the Manual of Operations by striking the following to SECTION 3 of the Operational Procedures (under Mission Commission entry):

~~They shall oversee the support and encouragement of new faith communities and new church development.~~

(For the Background/Rationale, see the Central Support Minutes – Attachment 7a))

(For a look at the NWC Manual that Mission Commission adopted as a working document toward this end, see **Attachment 7g – found in packet 2)**

5. ON MOTION to Amend the STANDING RULES of the Manual of Operations by amending the Description of the Presbytery: Description of the Presbytery

The Presbytery is a corporate expression of the church in Northwest Ohio and Southeastern Michigan. The Presbytery bears responsibility for ministry within the boundaries of the following counties in the State of Ohio: Allen, Auglaize, Crawford, Defiance, Erie, Fulton, Hancock, Hardin, Henry, Huron, Lucas, **Mercer**, Ottawa, Paulding, Putnam, Sandusky, Seneca, ~~Shelby (parts)~~, Van Wert, Williams, Wood and Wyandot, **and the First Presbyterian Church of Shelby in Richland County**. The Presbytery bears responsibility for ministry within the boundaries of the following counties in the State of Michigan: Lenawee and Monroe.

Background/Rationale: The recommendation seeks to correct errors found in the current standing rules, and return to the original definition of the presbytery as expressed in the Standing Rules in 1986. Over time slight errors were believed to have been made and copied forth. This revision has been reviewed by the Office of the General Assembly, who also believes this to be the corrected version/description of the presbytery. We do not believe there are fundamental changes to our definition (e.g. Mercer County and the church in Celina have always historically functioned as part of Maumee Valley).

Central Support Minutes

August 15, 2023 at 1pm via Zoom

Roll: Katie Treadway, TE, Central Support Moderator; Chas Myers, RE, Presbytery Moderator; Carole Burnworth, RE, Presbytery Vice Moderator; Ed Bettendorf, RE; Peter Haff, RE; Mary Beth McCandless, TE; Dane Nelson, RE; Ken Wessler, TE; Nan Clancy

Excused: Dane Nelson, RE, Nan Clancy TE

Matt Meinke, General Presbyter, Ex Officio; David Bartley, Treasurer, Ex Officio, Dean McGormley, Stated Clerk, Ex Officio

Call to Order with Prayer – Moderator of Central Support Katie Treadway

Clerk's Report – Dean McGormley

Treasurer's Report: - David Bartley

Year-End Financial Statement finished ok because not all funds were spent. Back Per Capita collection has slowed.

June Balance Sheet was presented.

David presented and recommended a new standard Mission Distribution: ON MOTION to recommend to Presbytery to replace former distribution (Presbytery 70%, Synod 27%, G.A. 3%) with a new distribution (Presbytery 75%, Synod 22%, G.A. 3%) So Ordered.

ON MOTION to recommend the 2024 presbytery budget to Presbytery for approval. (proposed budget has a \$.55 increase in per capita) So ordered

ON MOTION to recommend to MVP a \$.55 increase in the per capita for 2024 So Ordered. (New per capita total of \$39.10 with the \$.55 Pres increase and \$.05 G.A. decrease)

ON MOTION to receive the "INDEPENDENT MINI THIRD-PARTY FINANCIAL REVIEW" of MVP finances dated 7/25/2023.

INDEPENDENT MINI THIRD-PARTY FINANCIAL REVIEW REPORT

To the Board and Finance Committee of the Maumee Valley Presbytery

We have performed a MINI Third-Party Financial Review on the accompanying statement of assets, liabilities, and net assets – modified cash basis of the Maumee Valley Presbytery as of December 31, 2019/2020/2021/2022, and the related statements of support, revenues, and expenses, and of changes in net assets – cash basis for the years then ended. These financial statements are the responsibility of the Maumee Valley Presbytery management. Our responsibility is to express an opinion on these financial statements based on our MINI Third-Party

Financial Review

This MINI Third-Party Financial Review was performed via the Internet as opposed to on-site. It was performed in accordance with auditing standards generally accepted in the United States of America. We have adhered to those standards in the planning and performance of our MINI Third-

Party Financial Review to obtain reasonable assurance about whether the financial statements are free of material misstatement. We believe that our MINI Third-Party Financial Review provides a reasonable basis for our opinion.

Pauline Walker

Dated 07/25/2023

So Ordered

Moderator's Report – Chas Myers

Recommendation from Moderator Chas Myers to Central Support Commission: That Central Support recommend the following to Maumee Valley Presbytery:

ON MOTION to recommend to MVP for approval:

#1. Amend the Manual of Operations by adding the following to SECTION 3 of the Operational Procedures (following the Mission Commission entry):

NEW WORSHIPPING COMMUNITIES COMMISSION

The New Worshipping Communities Commission shall be composed of six (6) members, composed of ministers and ruling elders. The general presbyter and stated clerk are ex-officio members, without vote. Members should have experience, knowledge, expertise or willingness to undergo training in the area of New Worshipping Communities. Other individuals, including members and leaders of new worshipping communities, regardless of ordination status or congregational membership, may be invited by the commission to serve in a non-voting capacity when the commission determines such participation would support the commission's work and mission.

The commission shall serve the presbytery in the following ways:

- a. Establish, oversee, and dissolve all New Worshipping Communities and Fellowships, and their Task Forces/Leadership Teams. Each New Worshipping Community and Fellowship will be governed by a Task Force/Leadership Team authorized by the NWC Commission. The Task Force shall have responsibility and authority similar to that of a church session and appropriate to the context(including the calling of a leader), as determined by the NWC commission, and accountable to the NWC Commission and Leadership Commission in the case of pastoral calls.
- b. Maintain a Manual that governs the establishment, development, oversight, and processes for NWCs.
- c. Strategize the overall continued growth of new worshipping communities within the bounds of Maumee Valley Presbytery.
- d. Encourage and coordinate congregational efforts to engage in local or multi-congregational new worshipping community experimentation
- e. Pursuant to G-3.0109b, provide examination for leadership utilizing the approved terms of call, and dissolve the relationships of leaders of New Worshipping Communities and Fellowships. The membership status, pastoral calls, and ministry contracts of Ministers of Word and Sacrament serving New Worshipping Communities and Fellowships in Maumee Valley Presbytery will continue to be subject to the examination and approval process of the Leadership Commission (COM) in consultation with NWCC

- f. Distribute presbytery allocated resources in support of New Worshipping Communities and Fellowships.
- g. Monitor and evaluate the progress of New Worshipping Communities and Fellowships.
- h. Authorize the administration of the sacraments in New Worshipping Communities and Fellowships.
- i. Communicate regarding New Worshipping Communities and Fellowships, and report the commission's actions on behalf of the presbytery.
- j. Recommend that presbytery charter a New Church when appropriate, in consultation with Leadership Commission.

#2. Amend the Manual of Operations by striking the following to SECTION 3 of the Operational Procedures (under Mission Commission entry):

~~They shall oversee the support and encouragement of new faith communities and new church development.~~

Background/Rationale/Definitions:

The recommendation reflects the presbytery's clear intention toward vitality, through the past several months of visioning and empowering, to enshrine the work of a New Worshipping Communities Commission in the manual as a permanent commission (similar to Leadership Commission, Discipleship Commission, etc.). The seeds of this new avenue/structure began as a challenge by General Presbyter Matt Meinke in February 2023 to start 20 NWCs in the next 10 years. Michael Gerhling, regional representative for 1001 New Worshipping Communities was also present, equipping and resourcing. Matt's challenge was taken on by Mission Commission.

By May, an Open Space was offered before the May Presbytery meeting, which gathered and nourished many others in the presbytery who have a heart for NWC work. The volume of interest made it clear that the Mission Commission would soon be overwhelmed with NWC administrative duties and oversight if help was not recruited. One seed grant was already being sought. Others appear to be on the way. Since NWC Community development is currently under the purview of Mission Commission, they met in late May to strategize, adopt a new NWC manual, and recommended structural changes in our Standing Rules, by expanding to another standing committee – the New Worshipping Communities Commission. They adopted the new manual unanimously and asked the MVP Moderator to help nourish this new path.

The Moderator exercised his authority between stated meetings by appointing a New Worshipping Communities Commission, and similar to a “soft opening” appointed the current Mission Commission members to also be named as the members for the new NWC Commission, with a recommendation that as the number of NWCs grows and the work of the commission grows, new and separate members can be nominated and elected to serve. Structural changes to the Standing Rules then come to the September Presbytery meeting.

The effect of these changes/additions to the Manual of Operations would be to empower NWCs with a clear pathway for organizing and funding.

Definitions:

1. New Worshipping Community: All new congregations begin as new worshipping communities but not all new worshipping communities will become congregations. NWC's must be:

- A. *New: Seeking to make and form new disciples of Jesus Christ, while taking on varied forms of church for our changing culture. NWCs can be connected to an established church, but will have distinct leadership, funding, and future.*
 - B. *Worshipping: Gathered by the Spirit to meet Jesus Christ in Word and Sacrament, and sent by the Spirit to join God's mission for the transformation of the world.*
 - C. *Community: Practicing mutual care and accountability, while developing sustainability in leadership and finances.*
2. *Fellowship: Fellowships are stand-alone ministries operating under the umbrella of Maumee Valley Presbytery. Leadership and funding are similar to NWC requirements, without long-term sustainability requirements. Fellowships are often small in community size, and give expression to the Spirit's diversity and creativity.*

Vice Moderator's Report – Carole Burnworth

Report from Vice Moderator, Carole Burnworth as of August 1, 2023

Maumee Valley Presbytery worship

September 19, 2023 at First United Presbyterian Church Tecumseh – Rev. Cathi King along with Rev. Mary Beth McCandless and Lance Weisman organizing around theme of “Do Justice”; worshipful work (table based format) for worship.

Meeting schedule

November 14, 2023 at Findlay – Jessie Commeret on sabbatical; will work on planning when she returns

February 20, 2024 virtual – worship will be led by East Region group of small church leaders; specifically. Julie Kling, Bobbie, Bella, Rose Jones, Sara Hodsden and Don Loving. Theme not yet determined.

May 21, 2024 at First Presbyterian Church Monroe – Rev. Doris Chandler, worship plans not developed yet.

September 17, 2024 – waiting on a Session approval

November 19, 2024 10:00 am at First Presbyterian Church of Bryan – Rev. Leo Pech, worship plans not developed yet.

Moderators Conference

Thursday, November 9 at noon through Saturday, November 11, 2023 in Louisville and Zoom.

General Presbyter Report - Matt Meinke

Response to changes to Book of Order (Nationally and at Synod levels)

Standing Rules change to recommend to the Presbytery

Recommendation to Central Support Commission: That Central Support recommend the following to Maumee Valley Presbytery:

ON MOTION to recommend to MVP to Amend the STANDING RULES of the Manual of Operations by amending the Description of the Presbytery:

Description of the Presbytery

The Presbytery is a corporate expression of the church in Northwest Ohio and Southeastern Michigan. The Presbytery bears responsibility for ministry within the boundaries of the following counties in the State of Ohio: Allen, Auglaize, Crawford, Defiance, Erie, Fulton, Hancock, Hardin, Henry, Huron, Lucas, **Mercer**, Ottawa, Paulding, Putnam, Sandusky, Seneca, ~~Shelby (parts)~~, Van Wert, Williams, Wood and Wyandot, **and the First Presbyterian Church of Shelby in Richland County**. The Presbytery bears responsibility for ministry within the boundaries of the following counties in the State of Michigan: Lenawee and Monroe.

So Ordered.

Background/Rationale:

The recommendation seeks to correct errors found in the current standing rules, and return to the original definition of the presbytery as expressed in the Standing Rules in 1986. Over time slight errors were believed to have been made and copied forth. This revision has been reviewed by the Office of the General Assembly, who also believes this to be the corrected version/description of the presbytery. We do not believe there are fundamental changes to our definition (e.g. Mercer County and the church in Celina have always historically functioned as part of Maumee Valley).

Delinquent Per Capita Task Force Report - Ed Bettendorf

Nothing new to report at this meeting

Task Force for Grand Rapids and Bucyrus – updates

Ed reported that final letters are going out to Grand Rapids and Bucyrus with request for minimal funds and church records that are owned by PCUSA as part of their being removed from the rolls of MVP.

Report for Nominating Committee – MB McCandless

MB reported a little behind but will have report of Presbytery meeting. By consensus she be allowed to take nominations directly to floor without Central Support approval.

Docket Planning for September Meeting: Dean

A detailed docket has been presented from Cathi Kink et al incorporating worship throughout the meeting. Dean will build the docket around this draft docket.

Other Business

Closing Prayer Katie Treadway

Maumee Valley Presbytery
Income and Expense Statement
 Consolidated - June 2023 Income and Expense & 2024 Budget

		Current Period	Year to Date	Annual 2023 Budget	Proposed 2024 Budget
INCOME	4000				
CONTRIBUTION INCOME	4010				
ADMIN & GOVERNANCE INCOME	4030				
Per Capita Receipts - Pby	4034	6,011.98	79,951.31	121,048.50	117,693.90
Per Capita Receipts - Syn	4036	913.53	9,473.83	15,427.75	14,683.50
Per Capita Receipts - GA	4038	2,322.98	30,716.06	46,757.95	44,276.40
Per Capita Rece - Prior y	4040	0.00	7,229.43	15,000.00	5,000.00
Subtotal Admin & Governance Income	4030	9,248.49	127,370.63	198,234.20	181,653.80
PBY MISSION INCOME	4062				
Pby Progr & Mission Gifts	4068	3,744.72	38,392.83	96,000.00	80,250.00
Presbytery-Prior Year	4070	0.00	0.04	0.00	0.00
Subtotal Pby Mission Income	4062	3,744.72	38,392.87	96,000.00	80,250.00
OTHER INCOME	4090				
Synod Grant-Campus Ministry(old #4512-512)	4148-148	0.00	0.00	2,500.00	2,700.00
Other Income-Annuual Fund	4161	37.00	1,312.00	5,200.00	8,000.00
Int<Investments=drawdown	4162	24,447.81	24,447.81	63,800.45	66,334.33
Presbytery Events	4165-165	0.00	0.00	0.00	2,000.00
Triennium Income	4172-117	0.00	3,000.00	3,000.00	3,000.00
PDA Trip Registrations	4173-117	1,200.00	1,200.00	0.00	0.00
Spiritual Formation	4178-178	105.00	780.00	0.00	1,200.00
Rental Income	4185	0.00	3,000.00	0.00	6,000.00
Previous Year Surplus	4186	52,146.78	52,146.78	52,146.78	93,146.86
Subtotal Other Income	4090	77,936.59	85,886.59	126,647.23	182,381.19
Presbytery Designated					
Pby -Two Cents a Meal	4232-232	182.09	303.96	0.00	0.00
Pastoral Care Income	4236-236	773.00	1,277.00	0.00	0.00
Zion 4% drawdown inv.	4227-226	271.09	271.09	542.18	574.72
Camp Sale 4% drawdown in	4251-250	11,825.19	11,825.19	8,650.39	8,707.85
Pres. End. 4% drawdown i	4293-292	214.02	214.02	428.05	453.73
Subtotal Contribution Income	4010	13,265.39	13,891.26	9,620.62	9,736.30
DONOR DESIGNATIONS	4501				
Conger 4% drawdown inv.	4503-502	494.91	494.91	989.83	1,049.22
Triplett 4% drawdown inv	4505-505	56.70	56.70	113.44	110.12
Pby-Peace/Global Miss. Fu	4506-506	0.00	389.62	0.00	0.00
Synod Grant-Ohio Campus	4512-512	861.28	1,722.56	0.00	0.00
Subtotal Donor Designations	4501	1,412.89	2,663.79	1,103.27	1,159.34
TOTAL INCOME		105,608.08	268,205.14	431,605.32	455,180.63

EXPENSES	5000				
ADMINISTRATON & GOVER. EX	5011				
PBY DIRECTED PER CAPITA P	5012				
To Synod - Per Capita	5016	0.00	7,713.87	15,427.75	14,683.50
To General Assembly-Per C	5018	0.00	23,378.97	46,757.95	44,276.40
Subtotal Pby Directed Per Capita P	5012	0.00	31,092.84	62,185.70	58,959.90
VOLUNTEER REIM. MILEAGE	5019				
Leadership Commission	5020	67.13	143.13	2,000.00	2,000.00
Discipleship Commission	5024	0.00	0.00	250.00	250.00
Moderator	5028	0.00	0.00	500.00	500.00
Central Support/ACDC	5030	0.00	0.00	700.00	700.00
Mission Commission	5036	0.00	0.00	100.00	100.00
CRE Team	5040	0.00	0.00	100.00	100.00
Subtotal Volunteer Reim. Mileage	5019	67.13	143.13	3,650.00	3,650.00
PRESBY. EXP	5041				
General Assembly Commissi	5048	0.00	0.00	100.00	100.00
Commissions Expense	5050	0.00	0.00	750.00	750.00
Contingency - General	5052	0.00	0.00	1,000.00	1,000.00
Presbytery Meeting Arrang	5054	0.00	123.46	1,600.00	1,300.00
Moderator Expense	5056	0.00	0.00	800.00	800.00
Permanent Judicial Commis	5057	0.00	0.00	1,000.00	1,000.00
Subtotal Presby. Exp	5041	0.00	123.46	5,250.00	4,950.00
PERSONNEL & ADMIN	5060				
PRESBYTER EXP	5061				
Presbyter Salary	5062	4,056.71	24,340.26	48,680.50	50,773.76
Presbyter's Housing Allow	5063	2,841.67	17,050.02	34,100.00	35,566.30
SECA Match	5064	527.73	3,166.38	6,332.71	6,605.01
Presbyter Pension/HC/DD	5065	2,690.36	16,142.16	32,284.40	33,672.62
Presbytery Con Ed Budget	5066	0.00	2,000.00	2,000.00	2,000.00
Presbyter Con Ed Drawdown	5067	565.00	-1,435.00	0.00	0.00
Presbyter Professional Ex	5069	1,062.10	5,234.80	11,000.00	11,000.00
Presbyter General Assembly	5070	0.00	0.00	0.00	2,000.00
Subtotal Presbyter Exp	5061	11,743.57	66,498.62	134,397.61	141,617.69
STAFF EXPENSE	5077				
FIN/ADMIN OFFICE EXPENSE	5080				
FIN/ADMIN OFFICE SALARY	5081	4,546.21	27,277.26	54,554.50	56,900.34
FIN/ADMIN 403B	5082	83.33	499.98	1,000.00	1,000.00
FIN/ADMIN PENSION/HC/DD	5083	2,667.31	16,003.86	32,007.66	36,453.70
FIN/ADMIN Continuing Edu	5084	0.00	0.00	3,000.00	3,000.00
FIN/ADMIN Professional Ex	5086	230.08	398.24	700.00	700.00
Subtotal Fin/admin Office Expense	5080	7,526.93	44,179.34	91,262.16	98,054.04
OFFICE STAFF	5089				
Treasurer Expense	5090-090	233.83	245.83	750.00	750.00
Stated Clerk Salary	5092-092	623.34	3,740.04	7,480.00	7,480.00

Stated Clerk Expense	5094-092	0.00	12.00	2,500.00	2,500.00
Journal Clerk	5098-098	595.26	1,587.36	4,762.00	4,967.00
Journal Clerk Expense	5100-098	227.77	227.77	350.00	500.00
Webmaster Salary	5103	613.17	3,679.02	7,358.00	7,674.00
Subtotal Office Staff	5089	2,293.37	9,492.02	23,200.00	23,871.00
OTHER PAYROLL RELATED	5109				
Social Security Match	5110	429.33	2,350.59	5,000.00	5,000.00
HRA #2 Draw down	5111-113	399.51	-1,168.64	0.00	0.00
HRA #6 Draw down	5112-114	31.13	-2,210.30	0.00	0.00
Health Reimbursement HRA	5113-228	0.00	5,000.00	5,000.00	5,000.00
Professional Staff Devel.	5114	0.00	0.00	1,000.00	1,000.00
Workers Comp	5115	334.00	334.00	400.00	400.00
Subtotal Other Payroll Related	5109	1,193.97	4,305.65	11,400.00	11,400.00
Subtotal Staff Expense	5077	9,820.30	53,671.36	114,462.16	121,925.04
Subtotal Personnel & Admin	5060	22,757.84	124,475.63	260,259.77	274,942.73
OFFICE EXPENSE	5116				
Legal Service Fees	5117	0.00	0.00	3,000.00	3,000.00
Background Checks	5119	23.90	35.85	200.00	200.00
Audit Service Fees	5120	0.00	0.00	3,000.00	1,000.00
Office Rent	5130	1,402.33	8,413.98	16,828.00	16,828.00
Telephone/Internet	5132	394.40	2,276.78	4,500.00	4,500.00
Computer Consultant Fees	5134	309.99	1,379.16	2,750.00	3,000.00
Microsoft Server/Subscrip	5136	175.82	958.84	1,500.00	2,750.00
Software	5138	67.00	402.00	1,000.00	1,000.00
Stationery/Supplies	5140	290.82	1,536.75	3,000.00	3,000.00
Postage	5142	203.06	1,081.32	1,500.00	1,500.00
Resources/Subscriptions	5143	67.95	292.92	300.00	500.00
MVP Insurance	5146	448.40	2,670.00	5,258.00	5,400.00
Equipment Repair/Maint.,	5150	716.22	2,880.49	6,000.00	6,000.00
Equipment Replacement	5152	492.77	2,064.80	4,000.00	5,000.00
Checking Service Fees	5154	283.11	1,777.64	3,500.00	3,500.00
Paychex Service Fee & Mis	5156	96.53	650.62	700.00	1,500.00
Subtotal Office Expense	5116	4,972.30	26,421.15	57,036.00	58,678.00
Subtotal Administraton & Gover. Ex	5011	27,797.27	182,256.21	388,381.47	401,180.63
LEADERSHIP COMMISSION	5300				
COM Retreats/Training	5302	0.00	0.00	1,000.00	1,000.00
Pastoral Asst. & Sch. COM	5304	200.00	200.00	3,000.00	3,000.00
Pastor Recognition	5306	60.00	329.99	1,000.00	1,000.00
Subtotal Leadership Commission	5300	260.00	529.99	5,000.00	5,000.00
DISCIPLESHP COMMISSION	5317				
Beer Hymns	5320-174	0.00	0.00	50.00	0.00
Candidate Psychological T	5321	0.00	0.00	2,200.00	1,100.00
Spiritual Dirs/Transforma	5322-178	0.00	1,108.76	2,000.00	2,000.00
Session Minute Review	5326	0.00	22.88	50.00	50.00

Clerk Training	5327	0.00	0.00	100.00	100.00
Communion Training	5328	0.00	0.00	250.00	50.00
Discipleship Events	5329-165	0.00	2,000.00	500.00	3,000.00
Sunday School Curriculum	5330	0.00	0.00	1,000.00	1,000.00
Youth Events/Retreat	5331	0.00	0.00	3,600.00	3,600.00
Triennium Exp. Budget	5333	0.00	3,000.00	3,000.00	3,000.00
Triennium Exp. Used	5334	0.00	-3,000.00	0.00	0.00
Christian Educator Retrea	5335	0.00	0.00	500.00	500.00
Spirit. Formation Retreats	5341-178	1,492.40	1,318.30	3,000.00	3,000.00
Conferences Scholarships	5343	0.00	75.00	2,000.00	2,000.00
Boundary Training	5344-176	0.00	0.00	2,500.00	1,000.00
Preaching Track Class	5348	0.00	0.00	300.00	300.00
Commissioned Ruling Elder	5350-168	0.00	0.00	300.00	300.00

Subtotal Discipleship Commission	5317	1,492.40	4,524.94	21,350.00	21,000.00
----------------------------------	------	-----------------	-----------------	------------------	------------------

MISSION COMMISSION	5368				
MT-25 Racial/Economic Jus	5374	0.00	0.00	10,000.00	5,000.00
Kirkmont Support	5375	1,500.00	3,000.00	6,000.00	6,000.00
Campus Ministry - Toledo	5376-148	1,500.00	3,000.00	6,000.00	6,000.00
NWC Commission	5377	0.00	0.00	5,000.00	10,000.00
PDA Mission Trip	5379	0.00	0.00	1,000.00	1,000.00

Subtotal Mission Commission	5368	3,000.00	6,000.00	28,000.00	28,000.00
-----------------------------	------	-----------------	-----------------	------------------	------------------

TOTAL EXPENSES		32,549.67	193,311.14	442,731.47	455,180.63
----------------	--	------------------	-------------------	-------------------	-------------------

EXCESS INCOME/EXPENSES		73,058.41	74,894.00	-11,126.15	0.00
------------------------	--	------------------	------------------	-------------------	-------------

M E M O R A N D U M

TO: MAUMEE VALLEY PRESBYTERY

FROM: ED BETTENDORF, CHAIR OF CCCM

DATE: AUGUST 28, 2023

SUBJECT: REPORT (AND MOTION) IN RE CLOSING OF FOREST, FIRST

A. Background

On Thursday, August 3, 2023, pursuant to the decision of the remaining few Forest, First congregation members (of which there is a total of seven—albeit only four active), the Commission for Churches Concluding Ministry (CCCM)¹ met with the following members: Norla Strasbaugh (Clerk of Session), Karen Strasbaugh (Treasurer), Cynthia Strasbaugh Breidenbach, and Becky Snider (Financial Secretary)² to confirm their desire to close the church, which has not had formal Worship since November of 2022. Various issues were discussed and, subject to Presbytery’s ratification and/or approval (*see* Motion *infra*), decided as follows:

1. Pastoral Care (and, where appropriate, Transfers) of Members – All are already attending other churches or otherwise cared for. No “closing Worship” is wanted. To the extent that any transfers of membership are needed, the CCCM (again subject to Presbytery’s approval of the within Motion) will attend to them.
2. Church Finances – As of June 30, 2023, Forest, First has two financial accounts: (a) Regular Account in the amount of \$18,161.46 and (b) Business Account in the amount of \$28,224.77. The Regular Account is used for operating expenses. The Business Account, which consists of the proceeds of a 1995 sale of the church’s manse and several memorials, is a generally untapped resource. The remaining members requested leave, and CCCM agreed to allow, to donate some (\$6,698) of the Business Account to local mission and charities, including a Forest Food Pantry, Church in the Park, RHS Angel List, United Way of Hardin County, and Charlotte. The CCCM authorized the members to draw up to \$8,000 for this purpose. The CCCM deferred further allocations, if any, to the completion of all winding up activities.³

¹ Including Marie Loudon-Hanes, Lora Manon, Harry Tolhurst, Tom Jones, Ken Wessler, and Ed Bettendorf (Ashley Roberts did not attend).

² The other three (inactive) members are: Karen Strasbaugh (Norla, Karen, and Cynthia’s 95-year-old mother) and Cynthia’s two adult sons, Dustin (a resident of Belgrade, MT) and Ian (a resident of Findlay, OH). Karen is home-bound and living with Norla, who reports that Karen does not wish to join another congregation. Dustin and Ian are currently unchurched; however, a letter of inquiry as to disposition of their Forest, First membership has been sent to each of them.

³ To be sure, the CCCM did not rule out further allocations to local mission and charities. But in order to ensure adequate financial resources for utilities, maintenance, and like expenditures as to the church building and grounds, the CCCM decided to defer further allocations to Forest’s ultimate disposition, at which time the CCCM will revisit

3. Rolls, Records, and Other Worthy Historical Materials – Norla is collecting the church’s rolls and records; and taking an inventory of other worthy historical materials. The CCCM will assist her in curating and sending these items to the PC(USA)’s Historical Society (Philadelphia, PA), for digitalizing and storage. Funds for mailing this material will be drawn from Forest, First’s Regular Account.
4. Inventory of Church Personalty – Norla, with any help she requests from CCCM, will also inventory all church personal property, including (a) “Non-Religious Property” (e.g., office furniture, equipment, and supplies) and (b) “Religious Property” (e.g., Worship furniture, equipment, and supplies). Both Norla and her member colleagues will attempt to dispose of the “Non-Religious Property” within the local community (Forest, OH, and environs), such as Habitat for Humanity and similar charitable entities. Meanwhile, CCCM will seek to offer “Religious Property” to any church within the Presbytery that may have a need for such items. CCCM will also seek out other religious associations (that is, beyond the Presbytery, by and through web sites, donation centers, and the like).
5. Church Building – With the remaining active members’ concurrence, the CCCM decided that the church building, which, though aging, is in fair condition, should be sold as soon as possible. Asked whether they knew a realtor in whom they had confidence at or near Forest, OH, Norla and her colleagues recommended Regina Vent Realty Company. The CCCM authorized Becky Snider to contact Ms. Vent to inquire as to her interest in undertaking this sale. We will defer to the realtor’s market assessment as to asking price.⁴ It was decided that, for the time being, the several large stained glass windows that adorn the building should be left intact (that is, sold with the building).⁵ As for the organ, a still-working, appealing pipe instrument, the CCCM decided to carve out an exception to the realty sale—reserving the right to sell this item separately. The CCCM is looking into possible avenues of sale.
6. Transfer of Authority/Responsibility for Church and Accounts to Presbytery – Again with the active remaining members’ concurrence, the CCCM is targeting for a complete transfer of authority and responsibility for the Church and accounts to the Presbytery (acting by and through CCCM or other commission/committee as Presbytery determines—*see* the within Motion), as of **September 30, 2023**. This will include real property transfer (unless the building is sold earlier, in which case there will be no transfer of realty to Presbytery) and transfer of all personal property and financial accounts.

the subject. This, of course, will depend on the wants and needs of the Presbytery vis-à-vis local options, which will be considered further in due course.

⁴ Shortly after our 8/3/23 meeting, Becky advised that Vent Realty has agreed to sell the property. Paperwork is in process. Norla (on the church’s behalf) and Ed Bettendorf (on the CCCM’s behalf) will sign the contract when it is available.

⁵ If the building cannot be sold—the real estate market in Forest, OH (and environs) is greatly depressed—the stained glass may be parted out (though even these appurtenances may have limited marketability).

B. Motion to Presbytery

The CCCM hereby respectfully moves as follows:

That Presbytery approves and/or ratifies (a) dissolution of First Presbyterian Church of Forest, Ohio (hereinafter, “Forest, First”); and (b) the decisions and actions of the CCCM (consisting of Ed Bettendorf, Chair (RE Firelands), Tom James (TE), Marie Loudon-Hanes (RE Findlay), Lora Manon (RE Bryan), Ashley Roberts (RE Ottawa), Harry Tolhurst (RE Delphos), Ken Wessler (TE)), to date (as reported in Part A of this Memorandum); and that Presbytery grants the following additional authority to the CCCM:

1. To care for all the spiritual needs of the remaining members (active and inactive) of Forest, First, including, where necessary and appropriate, approving and otherwise transferring anyone’s membership to another church or denomination as requested by such member.
2. To dispose of the real and personal property of Forest, First, including (a) offering at little or no cost any and all “Non-Religious Property” and “Religious Property” (as exemplified above) to both local and regional charitable, religious, and/or other worthy entities; and retaining Regina Vent Realty Company to sell the church building at a reasonable, market-based asking price.
3. To transfer all real and personal property (if any) and all financial accounts to the CCCM, which shall hereby be authorized to assume original jurisdiction of Forest, First as a legal and PC(USA) entity for closing and winding up the ministry and mission of the church. This authority shall include, but not be limited to, responsibility for (a) curating and transferring all the rolls and records, together with any historical materials that CCCM deems worthy of preservation to the PC(USA)’s Historical Society (Philadelphia, PA); (b) dissolving the corporate existence of Forest, First as an Ohio non-profit corporation and otherwise completing the disposition of the affairs of the church.
4. To undertake any and all reasonable decisions and actions, whether or not specified herein, to complete the closing of Forest, First.

Respectfully submitted,

/s/ EdB.

Ed Bettendorf, Chair
MVP CCCM

ELB/ms

8/30/23 SUPPLEMENT TO REPORT

On August 29, 2023, after this Report was prepared, we received *and accepted* a \$40,000 cash offer on Forest, First. Closing is scheduled for September 29, 2023.

Respectfully submitted,

/s/ *EdB.*

Ed Bettendorf, Chair
MVP CCCM

ELB/ms

Nominations

The Central Support Commission has the responsibility to nominate persons to serve on the presbytery's committees, commissions, and representatives at synod and General Assembly (excluding nominations to the Central Support Commission which are made by the Leadership Commission). Central Support has appointed two members (MB McCandless, chair, and Peter Haff) to coordinate the work of a nominations team.

The nominations team places the following persons for nomination to the offices of moderator and vice moderator for 2024:

2024 Moderator of Maumee Valley Presbytery: Carole Burnworth, RE,
Eastminster

2024 Vice Moderator of Maumee Valley Presbytery: Douglas Holmes, TE, Blissfield,
Palmyra

Respectfully submitted:

MB McCandless, CS (chair); Peter Haff, CS; Ken Wessler, CS; Bobbi Bella; Don Loving; Diane Adams; Matt Meinke, ex-officio.